

A 3PE seamlessly integrated to the e-Series user experience!

NEW: e-Series TEACH PENDANT WITH 3-POSITION ENABLING DEVICE



A 3-position enabling teach pendant is now available as a variant for all payloads of e-Series robots, and as a UR+ component. The 3PE device is mechanically and functionally integrated with the e-Series Teach Pendant – just plug-and-play with any e-Series control box. Additionally, it is fully integrated into the Polyscope user interface to enable all robot motion, including Freedrive, in manual mode.

AT A GLANCE

- Full mechanical 3PE device integration
- Full software integration, providing a seamless e-Series user experience as the 3PE Teach Pendant is natively supported in Polyscope.
- Not only does it connect to the Control Box with the same connector as the standard e-Series Teach Pendant, but because the mounting points are identical, it can be mounted to any existing e-Series teach pendant brackets.
- Includes two 3PE devices, allowing comfortable use with left or right hand
- Compatible with all existing e-Series robots
- IP54 rated: dust and water resistant
- Evaluated by TUV NORD, included in certifications to ISO 10218-1:2011 and ISO 13849-1:2015

3PE for existing e-Series Robots

You can easily update your current e-Series robot by ordering the new 3PE Teach pendant.

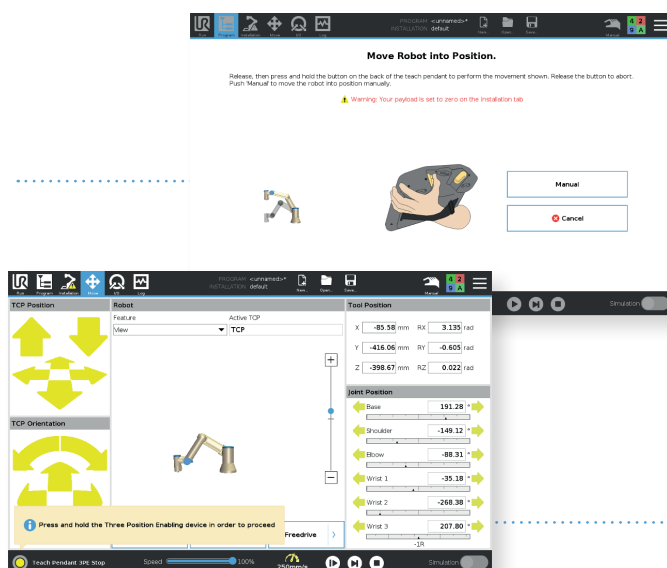

IN DETAIL

Width	300 mm	11.81 in
Height	231 mm	9.09 in
Thickness	50 mm	1.97 in
Weight, including 1 meter of cable	1.8 kg	3.961 lbs

 **UNIVERSAL ROBOTS**